

# Edwards St RoW between St Paul - Toledo

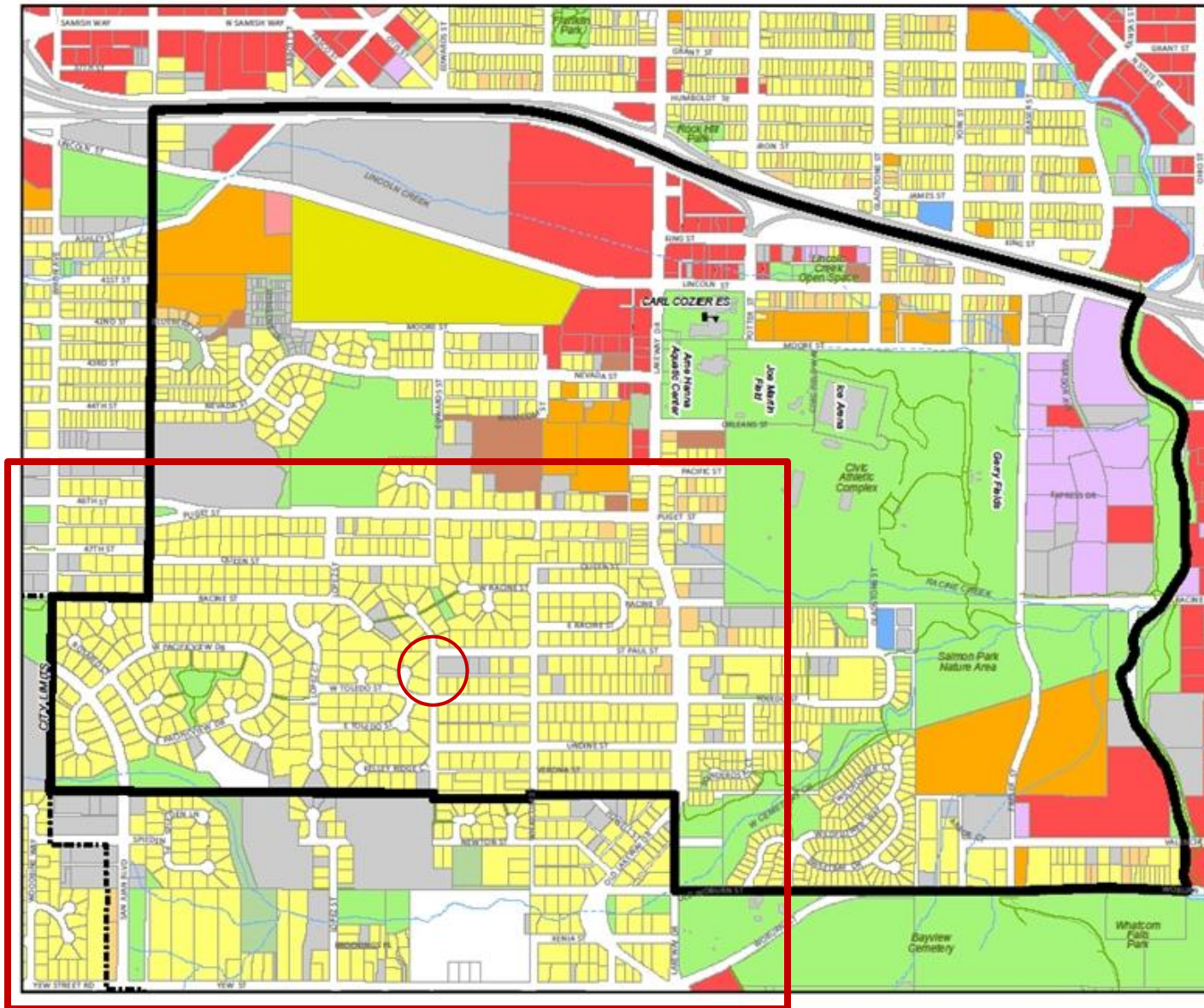

## PUGET NEIGHBORHOOD CURRENT USE

### Legend:

- City Limits
- Urban Growth Bndy.
- Neighborhood Bndy.
- Vacant Land\*
- Vacant Housing
- Single Family
- Mobile Home
- Duplex, Triplex, Fourplex
- 5+ Apartments
- Condominiums
- Mixed Use Res/Com
- Group Housing
- Commercial Land
- Industrial Land
- Resource Industry Land
- Port of Bellingham Land
- Public Land
- Quasi-Public Land

\*Vacant Land includes private land with assessed improvement values less than \$10,000 based on Whatcom County Assessor's records. Acreages shown on map are from City of Bellingham GIS and represent gross area.

\*\*Quasi-Public land includes private open space, religious facilities, private utilities, etc.

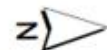

0 390 780 1,170 1,560 Feet

The City of Bellingham has compiled this information for its own use and is not responsible for any use of this information by others. The information found herein is provided simply as a courtesy to the public and is not intended for any third party use in any official, professional or other authoritative capacity. Persons using this information do so at their own risk and by such use agree to defend, indemnify and hold harmless the City of Bellingham as to any claims, damages, liability, losses or suits arising out of such use.



# Edwards St RoW between St Paul - Toledo





# Edwards St RoW between St Paul - Toledo

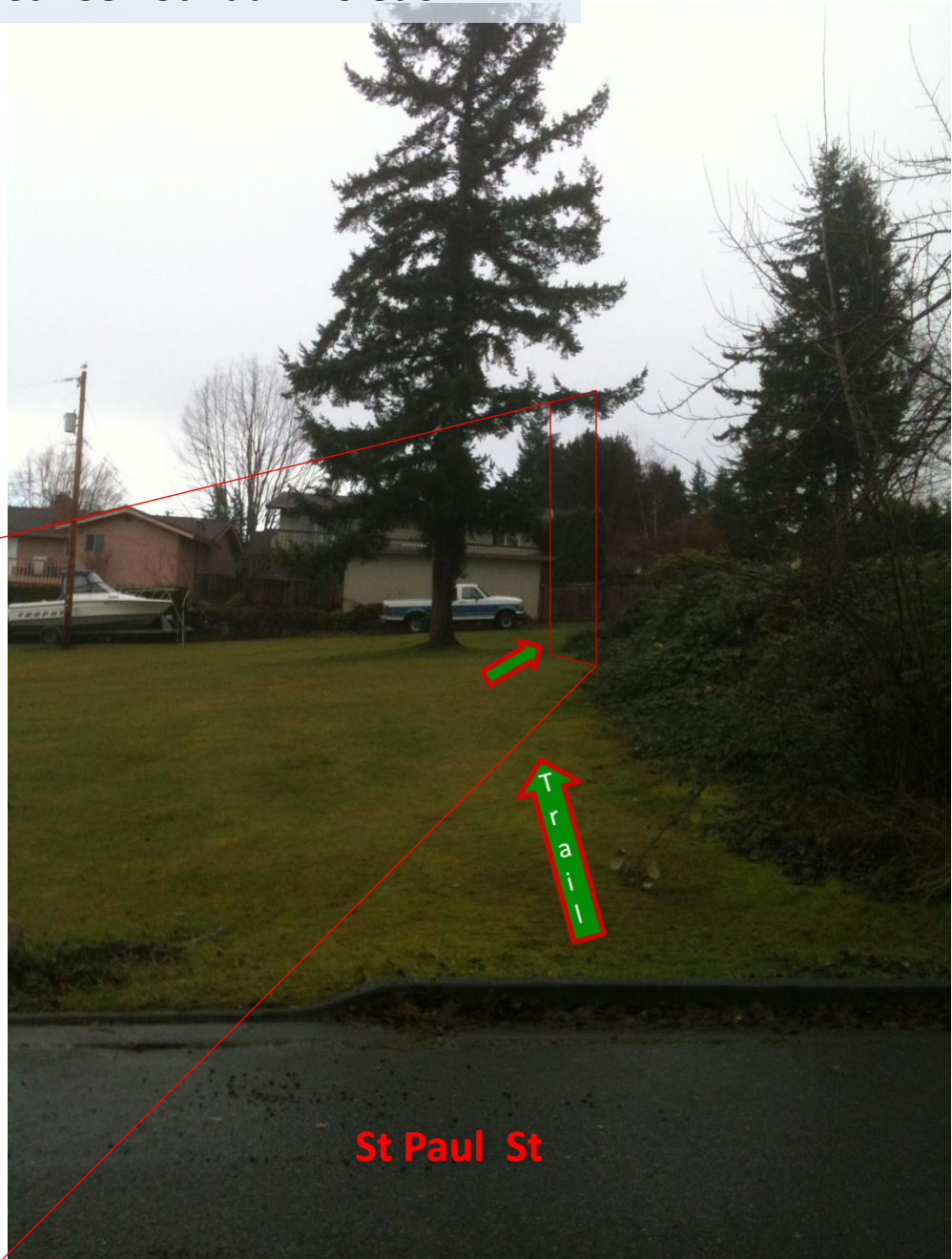



# Edwards St RoW between St Paul - Toledo

